

SEE SECTION 10

ZONING LEGEND

- R-1 ONE FAMILY RESIDENTIAL
- R-1-A ONE FAMILY RESIDENTIAL
- R-1-B ONE FAMILY RESIDENTIAL
- R-1-C ONE FAMILY RESIDENTIAL
- R-2 ONE FAMILY RESIDENTIAL
- R-3-12 MULTI FAMILY, LOW RISE
- HMR HIGH & MID RISE
- MHP MOBILE HOME PARK
- O-1 PROFESSIONAL OFFICE
- O-2 SERVICE OFFICE
- C-1 RETAIL BUSINESS, LOCAL
- C-2 LINEAR RETAIL BUSINESS
- C-3 SHOPPING CENTER BUSINESS
- C-4 GENERAL BUSINESS
- C-5 MULTI - USE
- C-6 SHELBY CENTER
- I-R INDUSTRIAL RESEARCH
- LM LIGHT MANUFACTURING
- HM HEAVY MANUFACTURING
- F-1 FLOODPLAIN
- REC RECREATION

- T-1 TRANSITIONAL
- CONSENT JUDGMENT OR DEED RESTRICTION
- CONDITIONAL REZONING
- PUD

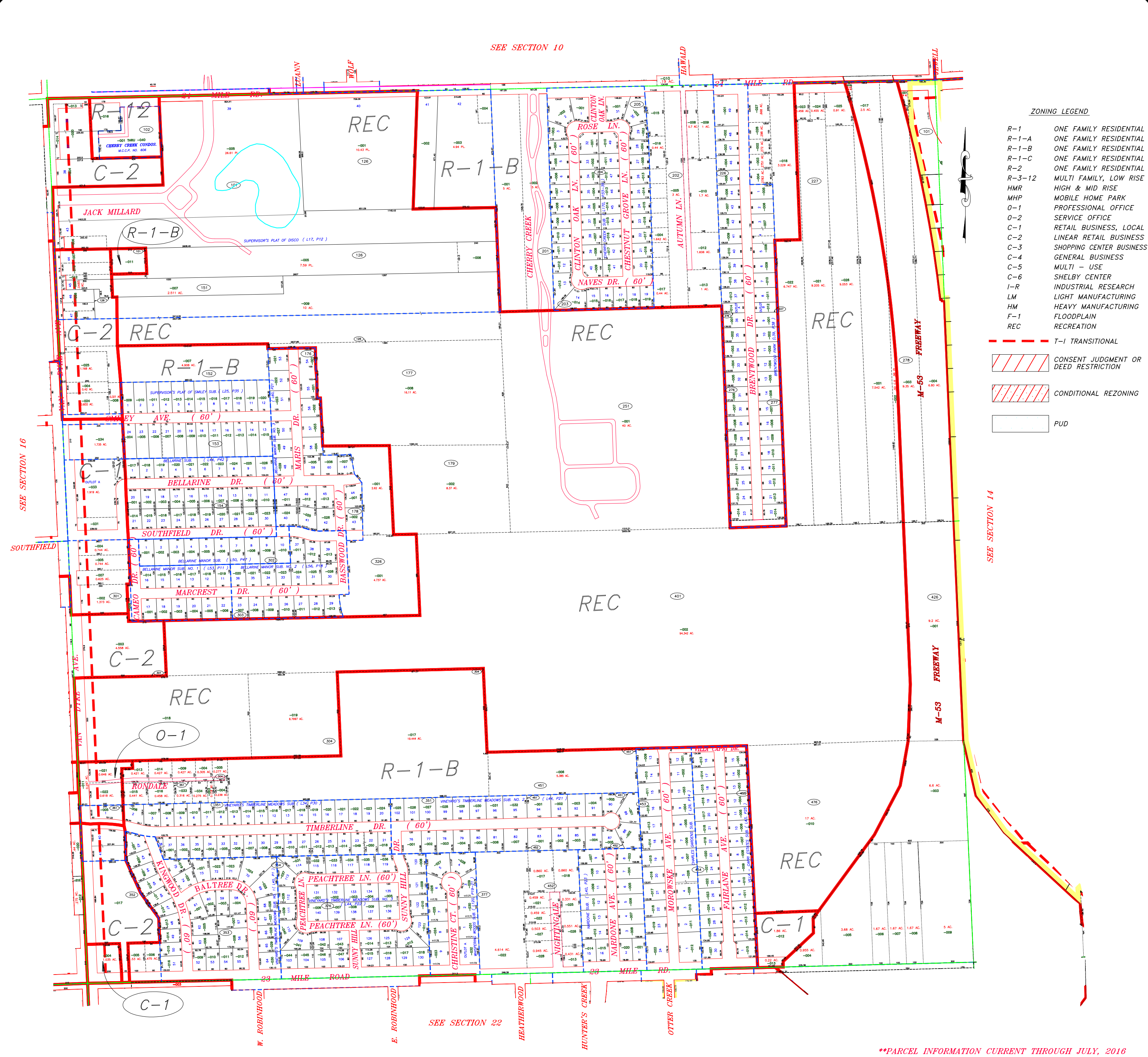

**PARCEL INFORMATION CURRENT THROUGH JULY, 2016

REVISIONS / UPDATES	DATE	REMARKS	DATE	REMARKS
	12-20-2010	ADDED ZONING		
	02-27-2012	STANLEY GROT		
	06-07-2013	PARCEL DESC. CORRECTION		
	03-2017	ZONING UPDATES		

FAZAL KHAN & ASSOCIATES, INC.
 CIVIL ENGINEERS & LAND SURVEYORS
 43279 SCHENKER STERLING HEIGHTS, MI 48313
 PHONE (586) 739-8007 FAX (586) 739-0904
 WWW.FAZALKHAN.COM

PLOT DATE: 12-20-2012 DRAWING DATE: 07-15-2010
 PLOT SCALE: 1" = 400' DRAWING SCALE: 1" = 400'
 PLOT CONFS: PROJECT NO: 17-400
 ATTACH XREF: DRAWING FILE: CHECKED BY: T

RICHARD STATHAKIS
SUPERVISOR

STANLEY GROT
CLERK

MICHAEL FLYNN
TREASURER

JOHN VERMEULEN
TRUSTEE

VINCE VIVIANO
TRUSTEE

LYNN WILHELM
TRUSTEE

DOUGLAS WOZNAK
TRUSTEE

Charter Township of Shelby

PARCEL BASE MAP

SECTION **15**

CAUTION
 THIS MAP IS INTENDED FOR REFERENCE PURPOSES ONLY. FAZAL KHAN & ASSOCIATES AND THE CHARTER TOWNSHIP OF SHELBY DO NOT GUARANTEE THE ACCURACY OF THE INFORMATION AND DISCLAIM ALL LIABILITY FROM ALL CLAIMS, SUITS, DEMANDS AND JUDGEMENTS ARISING FROM THE USE OF THIS INFORMATION.