



## Shelby Township Retail Profiles: VG's Supermarket - 50820 Schoenherr Road Southeast Corner of 23 Mile Road and Schoenherr Road

[www.shelbytp.org](http://www.shelbytp.org)



Real Estate Contact:  
NAI Farbman

Community Contact:  
Glenn Wynn, AICP  
Planning Director Shelby Township  
586-726-7243  
[planning@shelbytp.org](mailto:planning@shelbytp.org)

### Site Characteristics

- 6.5 Acres
- East side of Schoenherr Road south of 23 Mile Road
- Zoned C-1, Local Retail and Planned Unit Development (PUD)

### Population

- 1 Mile Radius - 5,757
- 3 Mile Radius - 70,858
- 5 Mile Radius - 197,149



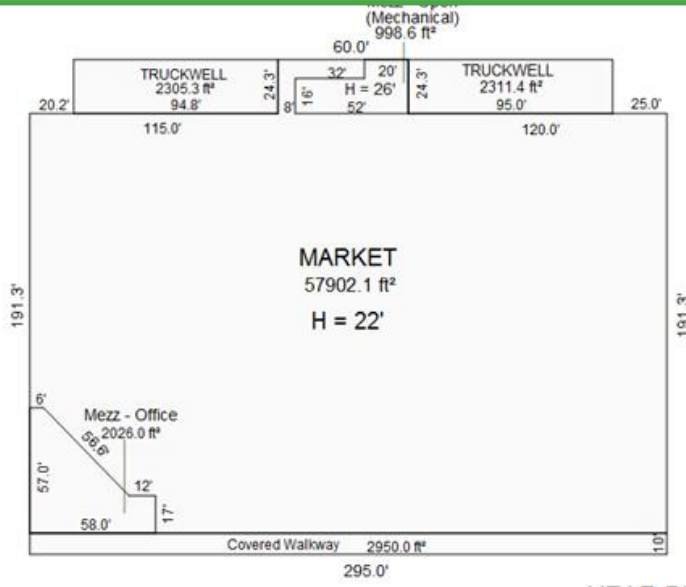

- Year Built: 2000
- Building Size: 57,902 sq. ft.
- Parking: 306 spaces; pmce space for each 189 square feet of floor area
- Public water and sanitary sewer are available to the site

FV 10/2/07: JB  
 Field Visit 5/04 mdb  
 Drawn 5/04 MDB

SCHOENHERR

YEAR BUILT = 2000  
 Heat = Package  
 = Space Ht Gas w/fan  
 Entire Building Sprinkled  
 Asphalt = 135,210 sf

- ### Households
- 1 Mile Radius - 2,305
  - 3 Mile Radius - 25,788
  - 5 Mile Radius - 74,953

- ### Median Household Income
- 1 Mile Radius - \$45,108
  - 3 Mile Radius - \$67,967
  - 5 Mile Radius - \$61,925

- ### Traffic Volume
- Schoenherr Road 12,480 to 13,490 vdp
  - 23 Mile Road: 16,220 vdp

