



# Special Report



## Shelby Township built a 26,400-square-foot library without a tax increase

Shelby Township Board, staff address needs of growing community by more than doubling the size of library without debt or library millage



**Macomb County's**  
Lowest-cost, full-service  
**Community**

**THE NEW LIBRARY INCREASES THE OLD FACILITY'S FOOTPRINT FROM 12,400 SQUARE FEET TO 26,400 SQUARE FEET. PAID IN CASH - NO DEBT- NO BONDING - NO TAX INCREASE**

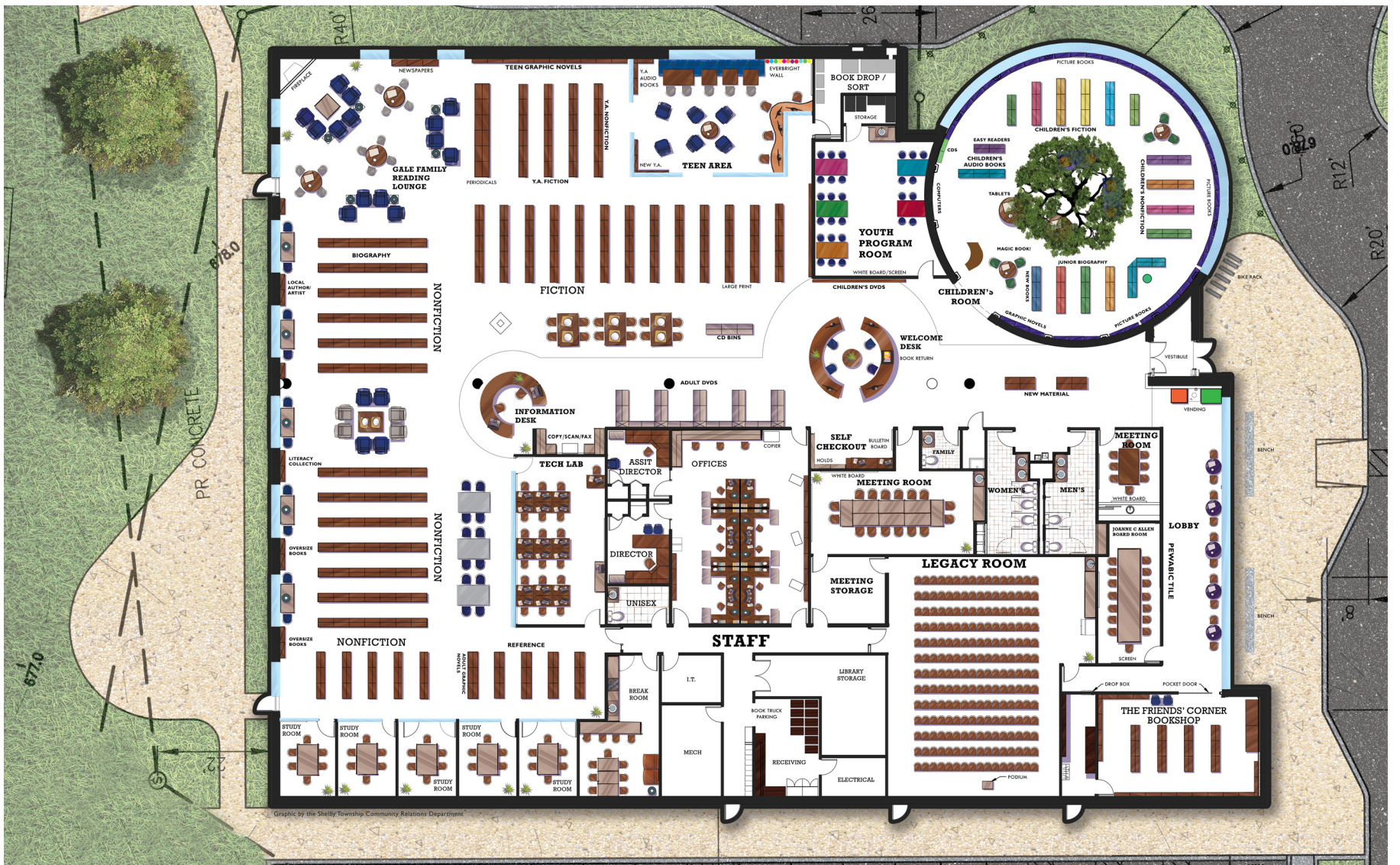

While the COVID-19 pandemic delayed the new Shelby Township Library's opening, the project finished within budget. The 26,400-square-foot facility, the township's first standalone library, opened its doors June 25, 2022.

**LIBRARY CONSTRUCTION STAYED WITHIN ITS \$11.7 MILLION BUDGET, PAID IN CASH WITH NO DEBT, NO BONDING AND NO INCREASE IN TAXES.**



Library landscaping added 53 trees, 120 shrubs, 67 evergreens, and 624 perennials and grasses to the campus.



The Children's Tree has 36 fireflies, four birds and three animals hiding in its limbs.



Nine meeting rooms range from the Legacy Room, the township's largest space, to five small semi-private study rooms.



The library sits under a standing seam roof and 12,600 square feet of wood ceiling.



The 26,400-square-foot library houses a collection of 110,000 items to serve 35,000 registered users.



The Shelby Township Library opened in August of 1972 with 4,500 books. In the first week, 515 residents got library cards.



The June 25, 2022, grand opening of the new Shelby Township Library honored the memory of Ron Black and Joanne Allen.



The library has 207 panes of electrochromic windows, which tint to protect the collection and reduce energy costs.



Nearly 115,000 patrons visited the library and checked out 266,000 items in the new library's first year.



The Shelby Township Library issued 4,200 library cards to new users in its first year in the new building.



**Katie Ester**  
**Shelby Township Library Director**  
 52610 Van Dyke Ave.  
 Shelby Township, MI 48316  
[www.shelbytp.org/library](http://www.shelbytp.org/library)  
 Phone: 586-739-7414  
[shelbylib@libcoop.org](mailto:shelbylib@libcoop.org)

**Re: Celebrating a Year of Community and Connection**

Dear Shelby Township neighbors:

As we celebrate our first anniversary in our beautiful new building, I look back on our remarkable journey of growth this year. The numbers are telling; painting the picture of a bustling community gathering place, learning space and community treasure.

Since our grand opening, the Shelby Township Library has stood as a beacon in our community embracing nearly 115,000 residents who walked through our welcoming doors. From our eager young readers, to lifelong learners, the numbers tell a story of success and engagement with a staggering 266,000 items checked out. This activity is a testament to the insatiable appetite for learning, culture and entertainment that resides within our community. We issued over 4,200 library cards to excited new users. We hosted 459 community programs that saw over 9,200 children, teens and adults visit the library in record numbers to enjoy our new programming spaces.

The numbers don't tell our complete story. Our residents are the main characters here. Our library staff loves watching patrons explore the new building with their mouths agape at our soaring wood ceilings. They're charmed by our beautiful seating areas awash in natural light from our panoramic windows that showcase our park setting.

Walk through our library any time of day and see every corner in use. By the fireplace, Jim reads a newspaper and swaps basketball stories with a fellow retired UCS teacher. Today, the dental and medical school students were the first in line for the private study rooms. The children's area is abuzz! Freshly arrived from feeding the ducks at Heritage Park, there are several sets of grandparents armed with juice boxes and sunscreen. They are guiding squirmy toddlers towards the Magic Book and Lego table. The Friends Corner Book Shop is busy with volunteers sorting donations and chatting with folks looking for a good deal on some gently used paperbacks they can take up north and leave behind in the cabin. In other corners of the library, there are book clubs, a writers group, a sensory-friendly movie screening, technology help, baby storytime and a dozen other tales underway.

This first year at your new Shelby Township Library was an incredible blockbuster, but truly, the story is just beginning. Join us for our next chapter...

Warmly,

Katie Ester  
 Shelby Township Library Director



Rick Stathakis  
 Supervisor

Stanley T. Grot  
 Clerk

James Carabelli  
 Treasurer

Lisa Casali  
 Trustee

Lucia Di Cicco  
 Trustee

John Vermeulen  
 Trustee

Vince Viviano  
 Trustee

**DESPITE A SIGNIFICANT INCREASE IN PATRONS SERVED, MATERIALS PROCESSED AND NEW LIBRARY CARDS, THE SHELBY TOWNSHIP LIBRARY CONTINUES TO OPERATE WITHOUT A DEDICATED LIBRARY MILLAGE.**

Patrons through the doors per month at the Shelby Township Library

7,927      11,158



old library

new library

New library cards per month at the Shelby Township Library

215      370



old library

new library

Library materials checked out per month at the Shelby Township Library

22,529      30,469

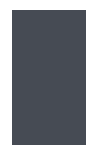

old library

new library

Patrons attending Shelby Township Library programs per month

643      938



old library

new library

**1.1517 MILLS FROM THE TOWNSHIP'S GENERAL FUND COVERS LIBRARY OPERATIONS. THE TOWNSHIP'S OVERALL 9.2999 LOCAL MILLAGE RATE, WHICH FUNDS ALL GENERAL FUND, POLICE AND FIRE SERVICES, IS THE LOWEST AMONG ALL FULL-SERVICE MACOMB COUNTY COMMUNITIES.**



586-739-7414  
shelbylib@libcoop.net  
52610 Van Dyke Ave.

Mon-Thu 9 AM-8 PM  
Fri-Sat 9 AM-5 PM  
Closed Sunday

**Katie Ester - Library Director**



## THE BENEFITS OF A FREE SHELBY TOWNSHIP LIBRARY CARD

Unlock a world of knowledge and inspiration at the Shelby Township Library. With your library card, explore a diverse collection of books spanning genres and subjects. Whether it's bestsellers, research materials or classic literature, the library has it covered. Beyond physical materials, delve into digital resources like **e-books**, **audiobooks**, **online courses** and **databases**, all accessible from home. The library's sense of community shines through **author talks**, **book clubs** and **workshops**, fostering connections and personal growth. Obtaining a library card isn't just about resources; it's joining a community that values learning. Discover enrichment and endless possibilities at the Shelby Township Library.

Visit the Shelby Township Library's 30-foot **Children's Tree** with 36 fireflies, four birds and three animals. We also have a one-of-a-kind interactive **"magic book."**



Browse our **graphic novels** and **manga** collection, and take your favorites to the teen room. Be sure to check out our interactive **Everbrite Wall**.



The library has a vast collection of adult and juvenile **DVDs**, **Blu-Ray** movies, TV shows and documentaries. We also have an extensive collection of **music CDs** and **audiobooks**.



Stop by the **Joseph and Karen Gale reading lounge** to read **newspapers**, **magazines** or selections from our **Local Author & Artist Collection** by the **floor-to-ceiling fireplace**.



Check out one of our **Story Boxes**. Each box comes with everything you need for your storytime. We also have **STEM Explorer Kits** and **Book Club Kits** for adults.



The Shelby Township Library has **24 computers** catering to youths, teens and adults. **Scanning** documents to an email or flash drive is free.

### Library Services

#### Fax

- The library sends domestic faxes for \$1 per page. The library does not receive faxes or send international faxes.

#### Printing

- Black-and-white prints run \$0.10 per page, and color prints are \$0.25.

#### WiFi Access

- The library provides wireless internet access anywhere in the building.

#### Wireless Hotspots

- Hotspots are accessible to Shelby Township residents 18 and older in good standing with a valid ID and a Shelby Township Library Card.

#### Programs

- Check the events calendar at [shelbytwp.org/library](http://shelbytwp.org/library). Youth programs include storytimes and activities. Teens have various teen meet-ups. Adults can join a book club or afternoon and evening programs.

### Digital Services

Visit [shelbytwp.org/library](http://shelbytwp.org/library) for a host of items. Navigate some of the site's most popular items, following these steps:

- Browse our "Online Resources," which include educational resources, online databases, the SLC mobile app and more.
- With your library card, follow the "Catalog Log-in" prompt to manage items, renew materials and place holds.

The Shelby Township Library provides an array of online content and services at [shelbytwp.org/library](http://shelbytwp.org/library). Access these offerings and more from home by logging in with your library card. The library extends subscriptions to the subsequent digital resources for all its patrons:

- Hoopla
- Libby by Overdrive
- Michigan eLibrary (MeL)
- ComicsPlus
- Mango Languages
- Tutor.com



"Shelby Township Library Special Report" is published by the Shelby Township Community Relations Department

Charter Township of Shelby, Macomb County, MI

PHONE 586-254-7130 - [info@shelbytwp.org](mailto:info@shelbytwp.org) - [shelbytwp.org](http://shelbytwp.org)