

SEE SECTION 29

ZONING LEGEND

- R-1 ONE FAMILY RESIDENTIAL
- R-1-A ONE FAMILY RESIDENTIAL
- R-1-B ONE FAMILY RESIDENTIAL
- R-1-C ONE FAMILY RESIDENTIAL
- R-2 ONE FAMILY RESIDENTIAL
- R-3-12 MULTI FAMILY, LOW RISE
- HMR HIGH & MID RISE
- MHP MOBILE HOME PARK
- O-1 PROFESSIONAL OFFICE
- O-2 SERVICE OFFICE
- C-1 RETAIL BUSINESS, LOCAL
- C-2 LINEAR RETAIL BUSINESS
- C-3 SHOPPING CENTER BUSINESS
- C-4 GENERAL BUSINESS
- C-5 MULTI - USE
- C-6 SHELBY CENTER
- I-R INDUSTRIAL RESEARCH
- LM LIGHT MANUFACTURING
- HM HEAVY MANUFACTURING
- F-1 FLOODPLAIN
- REC RECREATION

- - - T-1 TRANSITIONAL
- [Hatched Box] CONSENT JUDGMENT OR DEED RESTRICTION
- [Diagonal Lines Box] CONDITIONAL REZONING
- [Dotted Box] PUD

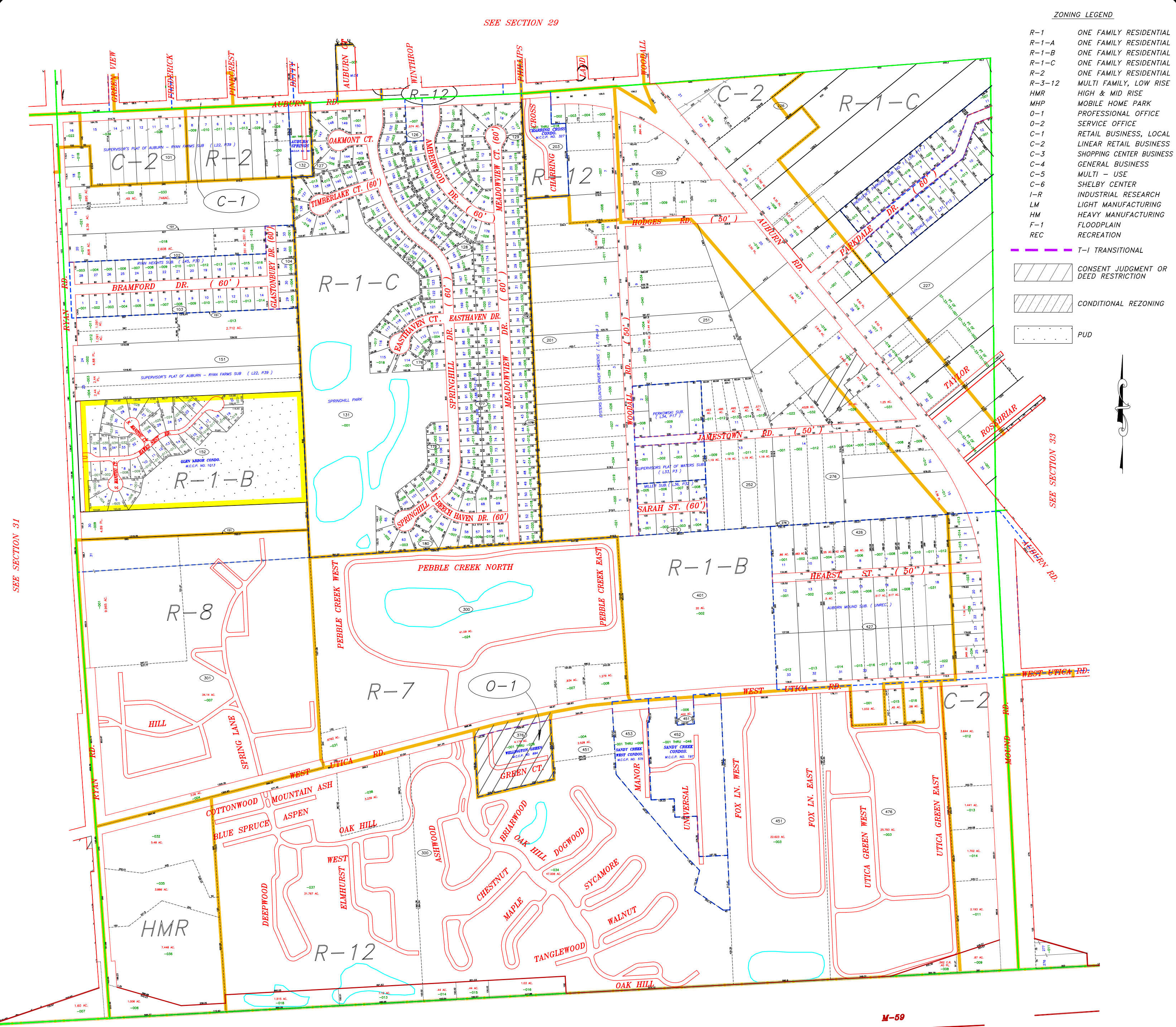

SEE SECTION 31

SEE SECTION 33

M-59

M-59

M-59

CITY OF STERLING HEIGHTS

**PARCEL INFORMATION CURRENT THROUGH JULY, 2016

REVISIONS / UPDATES	DATE	REMARKS	DATE	REMARKS
	12-20-2010	ADDED ZONING		
	02-27-2012	STANLEY GROT		
	11-18-2016	ZONING REVISION		
	03-2017	ZONING UPDATES		

FAZAL KHAN & ASSOCIATES, INC.
 CIVIL ENGINEERS & LAND SURVEYORS
 43279 SCHENBERG STERLING HEIGHTS, MI 48313
 PHONE (586) 739-8007 FAX (586) 739-6904
 WWW.FAZALKHAN.COM

PROJECT NO: 1514-D
 DRAWING FILE: 1514-D
 DRAWN BY: [] CHECKED BY: []

RICHARD STATHAKIS
 SUPERVISOR

STANLEY GROT
 CLERK

MICHAEL FLYNN
 TREASURER

JOHN VERMEULEN
 TRUSTEE

VINCE VIVIANO
 TRUSTEE

LYNN WILHELM
 TRUSTEE

DOUGLAS WOZNAK
 TRUSTEE

Charter Township of Shelby

PARCEL BASE MAP

SECTION **32**

*ALL RIGHTS RESERVED

CAUTION

THIS MAP IS INTENDED FOR REFERENCE PURPOSES ONLY. FAZAL KHAN & ASSOCIATES AND THE CHARTER TOWNSHIP OF SHELBY DO NOT GUARANTEE THE ACCURACY OF THE INFORMATION AND DISCLAIM ALL LIABILITY FROM ALL CLAIMS, SUITS, DEMANDS AND JUDGMENTS ARISING FROM THE USE OF THIS INFORMATION.