

SEE SECTION 5

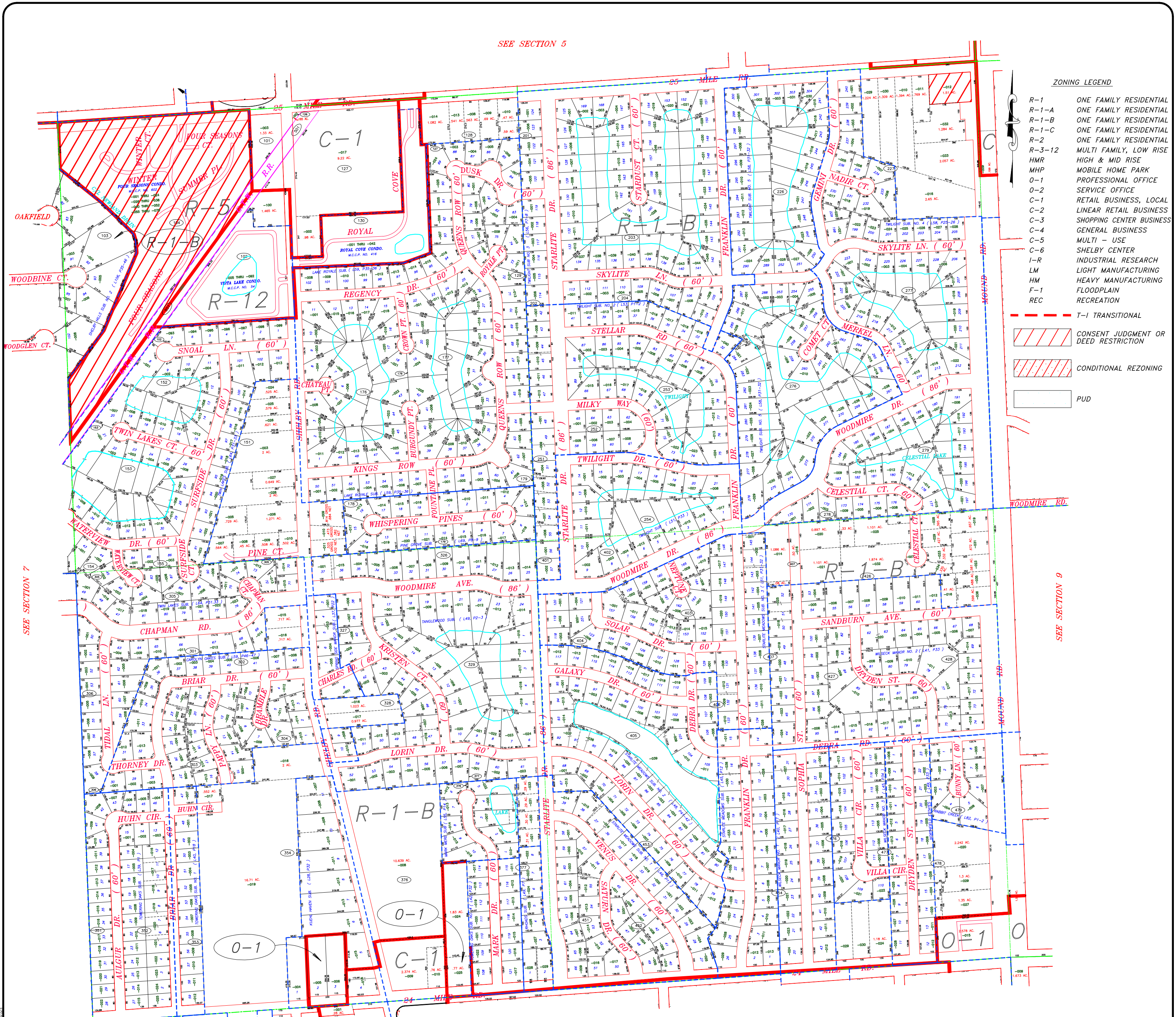

ZONING LEGEND

- R-1 ONE FAMILY RESIDENTIAL
- R-1-A ONE FAMILY RESIDENTIAL
- R-1-B ONE FAMILY RESIDENTIAL
- R-1-C ONE FAMILY RESIDENTIAL
- R-2 ONE FAMILY RESIDENTIAL
- R-3-12 MULTI FAMILY, LOW RISE
- HMR HIGH & MID RISE
- MHP MOBILE HOME PARK
- O-1 PROFESSIONAL OFFICE
- O-2 SERVICE OFFICE
- C-1 RETAIL BUSINESS, LOCAL
- C-2 LINEAR RETAIL BUSINESS
- C-3 SHOPPING CENTER BUSINESS
- C-4 GENERAL BUSINESS
- C-5 MULTI - USE
- C-6 SHELBY CENTER
- I-R INDUSTRIAL RESEARCH
- LM LIGHT MANUFACTURING
- HM HEAVY MANUFACTURING
- F-1 FLOODPLAIN
- REC RECREATION

- - - T-1 TRANSITIONAL
- [Diagonal Lines] CONSENT JUDGMENT OR DEED RESTRICTION
- [Cross-hatch] CONDITIONAL REZONING
- [White Box] PUD

SEE SECTION 7

SEE SECTION 9

SEE SECTION 17

\*\*PARCEL INFORMATION CURRENT THROUGH JULY, 2016

REVISIONS / UPDATES	DATE	REMARKS	DATE	REMARKS
	12-20-2010	ADDED ZONING		
	12-20-2011	PARCEL SPLITS / CORRECTIONS		
	02-27-2012	STANLEY GROT		
	06-07-2013	PARCEL COMBINATION		
	11-18-2016	2016 ZONING CHG		
	03-2017	ZONING UPDATES		

**FAZAL KHAN & ASSOCIATES, INC.**  
 CIVIL ENGINEERS & LAND SURVEYORS  
 43279 SCHORNER STERLING HEIGHTS, MI 48313  
 PHONE (586) 739-8007 FAX (586) 729-6994  
 WWW.FAZALKHAN.COM

PLOT DATE: 12-20-2012 DRAWING DATE: 07-15-2010  
 PLOT SCALE: 1" = 400' DRAWING SCALE: 1" = 400'  
 PLOT CONFS: PROJECT NO: 514-D  
 ATTACH XREF: DRAWING FILE: DRAWN BY: [ ] CHECKED BY: [ ]

**RICHARD STATHAKIS**  
SUPERVISOR

**STANLEY GROT**  
CLERK

**MICHAEL FLYNN**  
TREASURER

**JOHN VERMEULEN**  
TRUSTEE

**VINCE VIVIANO**  
TRUSTEE

**LYNN WILHELM**  
TRUSTEE

**DOUGLAS WOZNIAK**  
TRUSTEE

# Charter Township of Shelby

## PARCEL BASE MAP

SECTION **8**

\*ALL RIGHTS RESERVED

**CAUTION**

THIS MAP IS INTENDED FOR REFERENCE PURPOSES ONLY. FAZAL KHAN & ASSOCIATES AND THE CHARTER TOWNSHIP OF SHELBY DO NOT GUARANTEE THE ACCURACY OF THE INFORMATION AND DISCLAIM ALL LIABILITY FROM ALL CLAIMS, SUITS, DEMANDS AND JUDGEMENTS ARISING FROM THE USE OF THIS INFORMATION.